



# SYSTEQ

## Connecting a Receiver to the Homeelife App or Switchplate User Manual

### **SYSTEQ Limited**

47 The Wenta Business Centre  
Colne Way  
Watford  
Hertfordshire  
WD24 7ND  
United Kingdom

Tel: +44 (0)1923 605 301

Email: [support@systeq.co.uk](mailto:support@systeq.co.uk)

## Contents

Introduction	Page 3
Introduction to a receiver	Page 3
Installing the Homeelife App	Page 3
Setup the App	Page 5
Pairing a receiver to the app	Page 9
Introduction to a switch plate	Page 13
Preparing a switch plate	Page 13
Pairing a switch plate (Physically)	Page 14
Pairing a switch plate (Via app)	Page 15

## Introduction:

This document will guide you through the process of; Downloading the Homeelife app, Pairing a H2A receiver to the Homeelife app, and resetting a receiver to factory settings.

Screenshots from this guide will be from an Android device, and will work the same way for an Apple device.

## Introduction to a receiver:

The receiver used for this guide will be a smart dimmer, TEQ-SB9040A-S-EN. The receiver connects to the mobile device using Bluetooth.

### The reset button:

Used both to connect the receiver to the H2A app or a switch plate, and, to do a factory reset of the receiver (Press for 30 seconds to factory reset).

### L (Live) Connection:

Takes AC input providing power to the receiver

### N (Neutral) Connection:

Completes the circuit.

(Note: both live inputs are connected as are both neutrals)

### Out Connection:

Sends power from the receiver to the output device (lamp, luminaire, socket, etc.)



## Installing the Homeelife app:

Open your app store and type "homeelife" into the search bar:



Scroll until you find the app shown below:

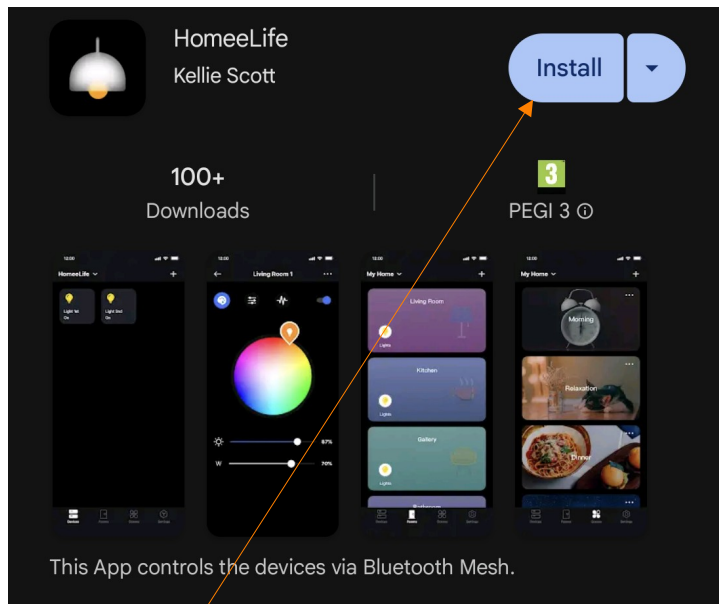

Tap on the install to install the app or the icon to get more information, then on install:

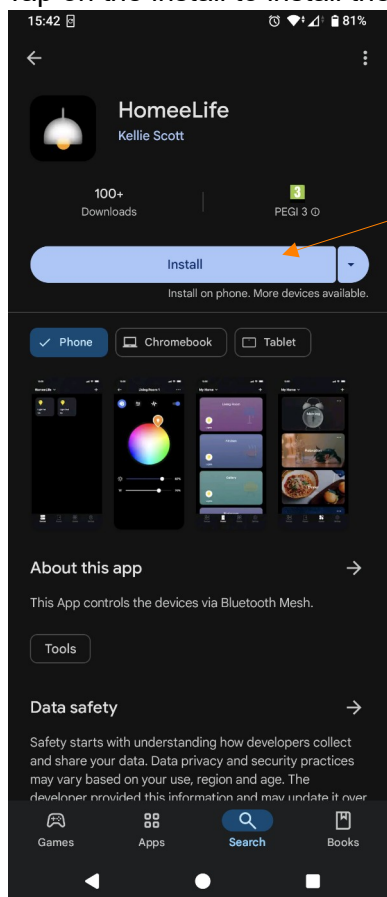

your app store will then install the app onto your device:

## Setup the App:

To start setting up the app, first tap on the app icon to open

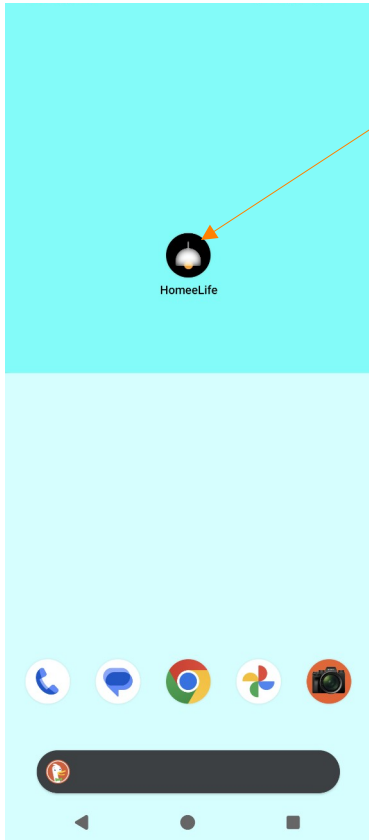

On the next screen tap on the start button

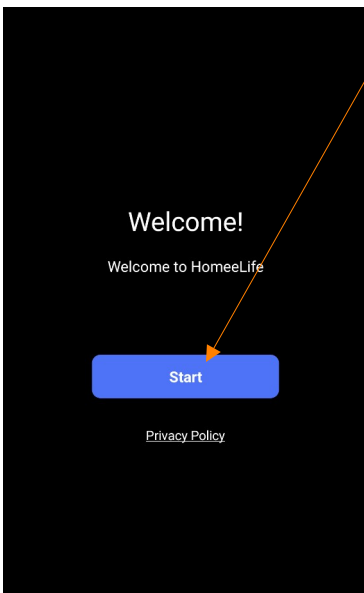

To enable the discovery of Bluetooth mesh receivers on the App, tap on Allow:

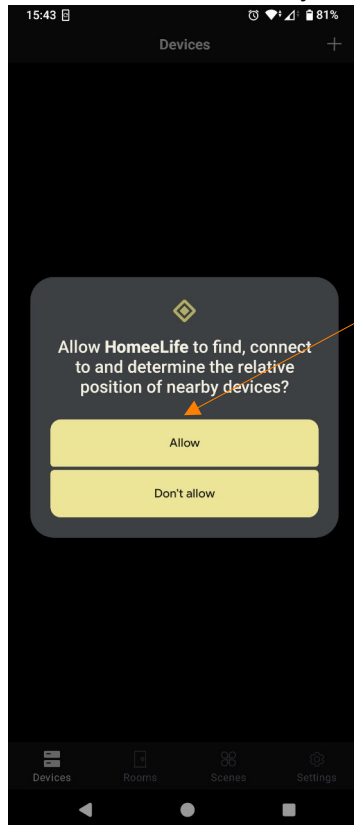

You will then be shown the Devices page. Tap on the “Settings” tab at the bottom right:

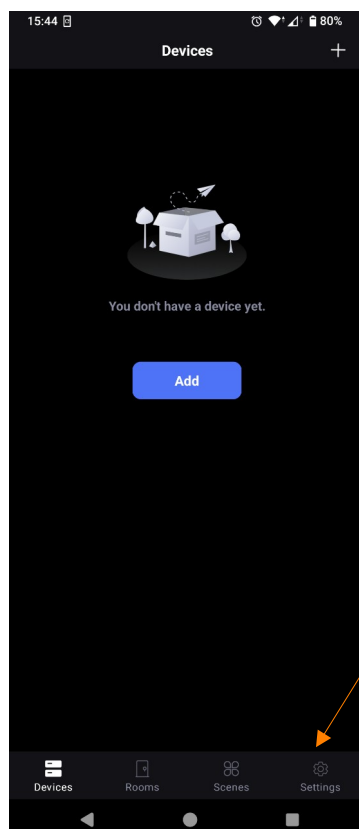

Tap on the “Sign In” option:

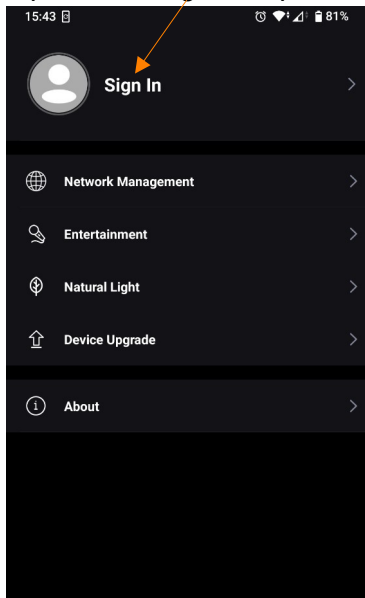

Tap on the “Sign Up” button:

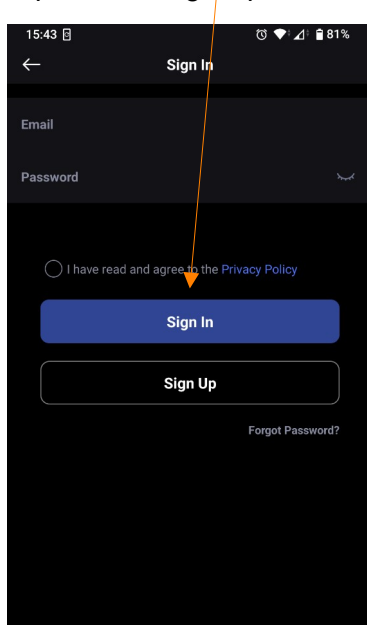

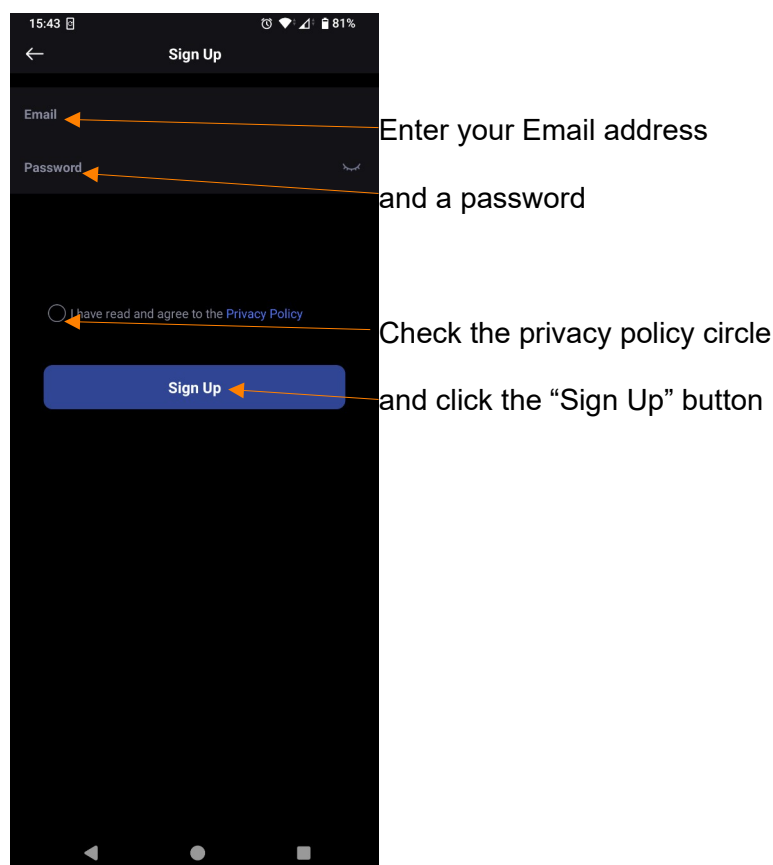

You can then use the email and password to sign into the app. (This email and password will also connect the hub to the Amazon Alexa or Google Home apps)

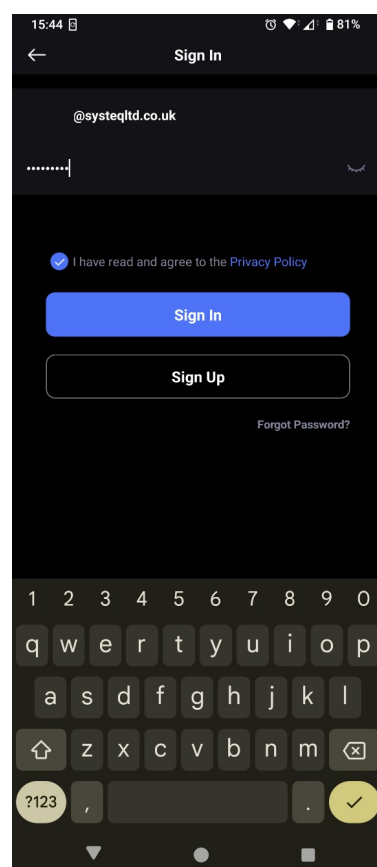



If you see a screen like this, you have successfully setup the App for use.

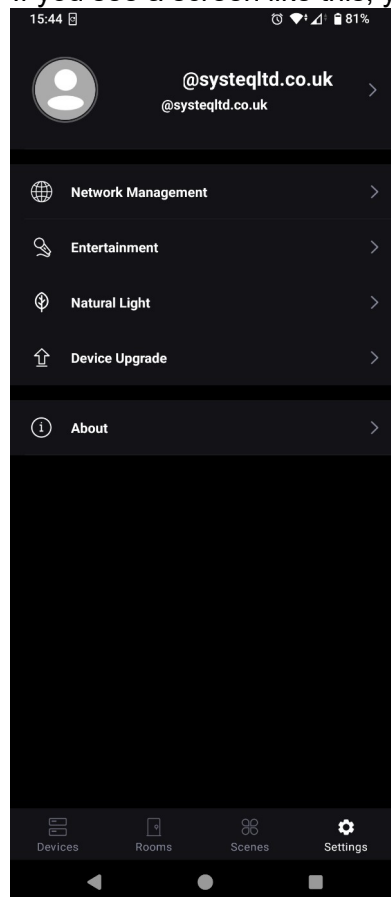

## Pairing a receiver to the App:

To pair a receiver to the App you first need to return to the devices tab by tapping “Devices” on the bottom left

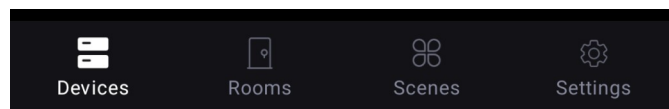

To add a new receiver tap on either the “+” or the “Add” button:

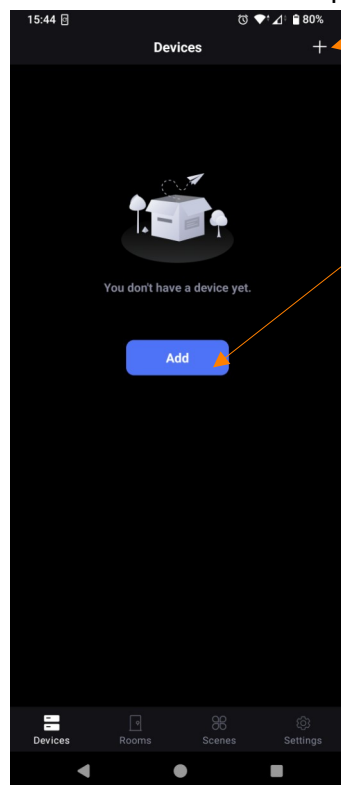

When you get to this screen, tap the programming button on the receiver twice (e.g. for dimmer the reset is also the programming button)

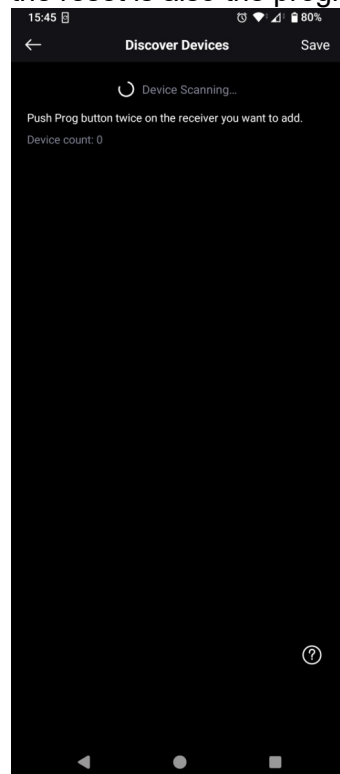

The receiver should show up on the screen as shown below. (Note you can add multiple receivers at the same time). Once you have all the receivers you want to add press “Save”.

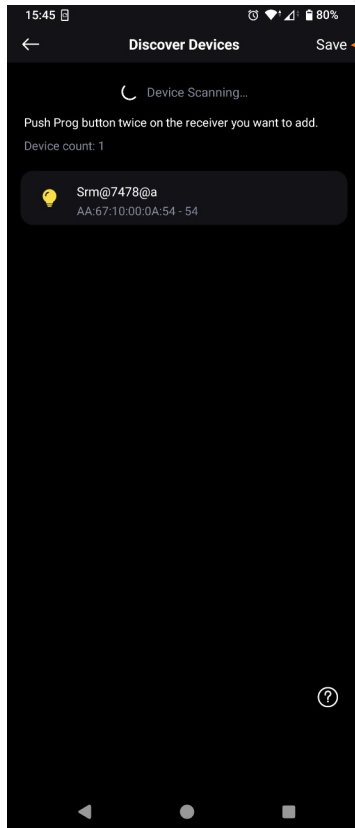

The screen below will show while the devices are being connected to the app.

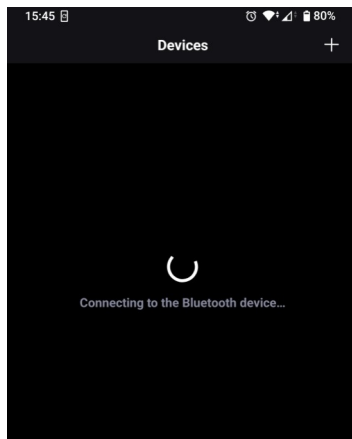

You may see this screen if the receivers are having trouble connecting. Tap the “Try Again”

button repeating a few times if needed. If this doesn't work then try adding the receiver again.

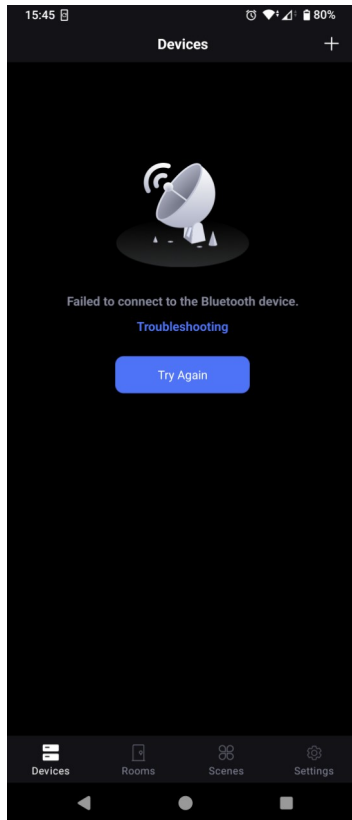

When the receivers connect you will see them on the devices page. Tapping on them will turn the light on and off, a long press will take you to more receiver control and setting options.

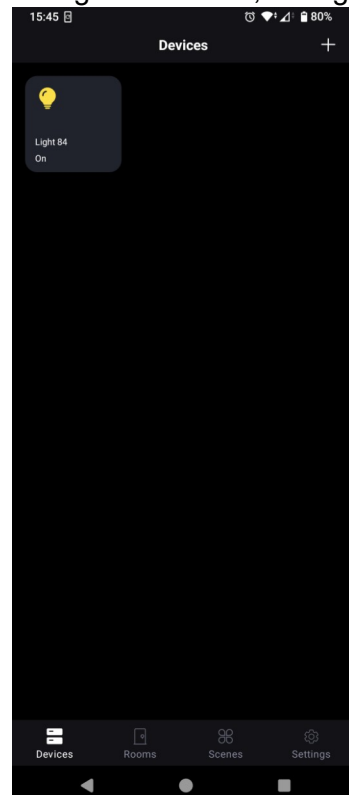

## Introduction to a switch plate:

The switch plate used for this guide will be the TEQ-SB1001-K8-G1-S4. The switch plate will connect directly to receivers.

**Status LED:** Shows button presses and pairing

**On switch:** Turn receiver on.  
(long press dim up)

**Dim up:** Increase light level of the receiver.

**Scene 1:** Load First scene in receiver.  
(long press set scene)

**Scene 3:** Load First scene in receiver.  
(long press set scene)

**Off switch:** Turn receiver off  
(long press dim down)

**Dim Down:** Decrease light level of the receiver.

**Scene 2:** Load Second scene in receiver.  
(long press set scene)

**Scene 4:** Load Second scene in receiver.  
(long press set scene)

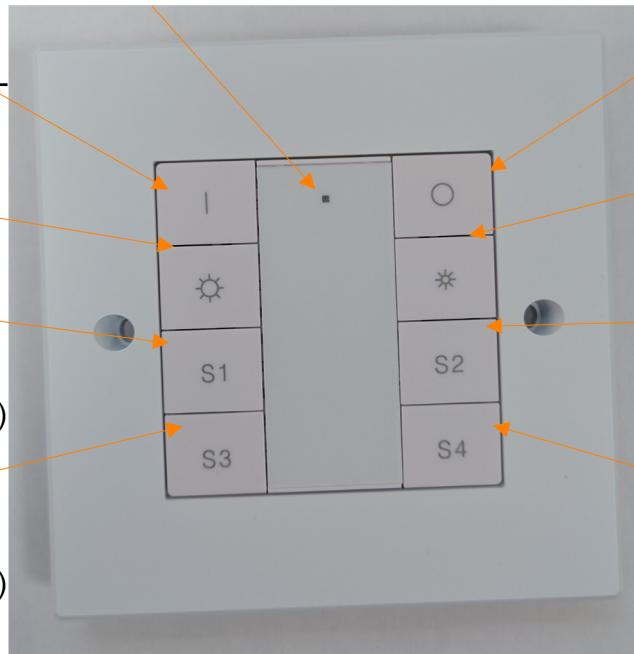

## Preparing a switch plate:

(Note: On kinetic switch plates there is no battery, so this step can be skipped).

To get a switch plate ready, turn it over and locate the battery compartment:



Open the battery compartment and remove the plastic blocker to enable the battery to power the switch plate, then cover the compartment back up.



### Pairing a switch plate (Physically):

To pair a switch plate to a receiver you first press the programming button twice, then you press the turn on button on the switch plate, until the status LED on the top middle of the switch plate and the any luminaires connected to the receiver flash to confirm pairing.

Press “reset” twice



Press “on” button

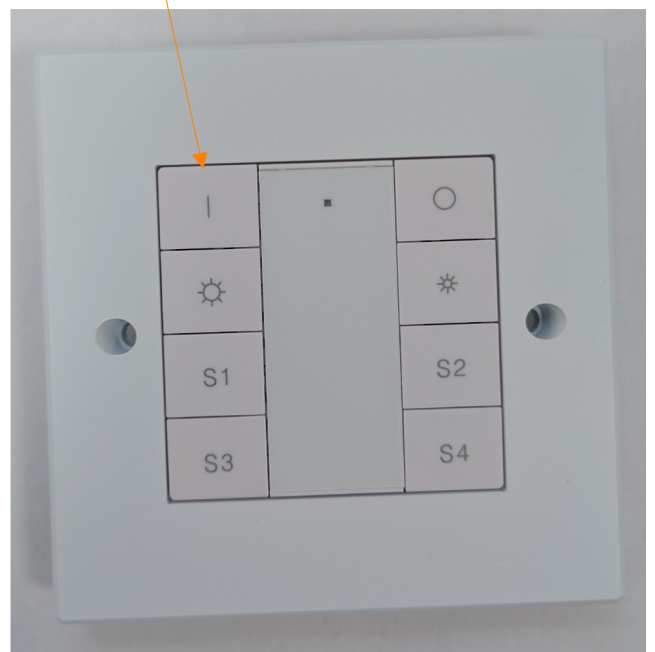

## Pairing a switch plate (Via app):

To pair a switch plate to a receiver via the app, first press and hold the receiver you want to pair.

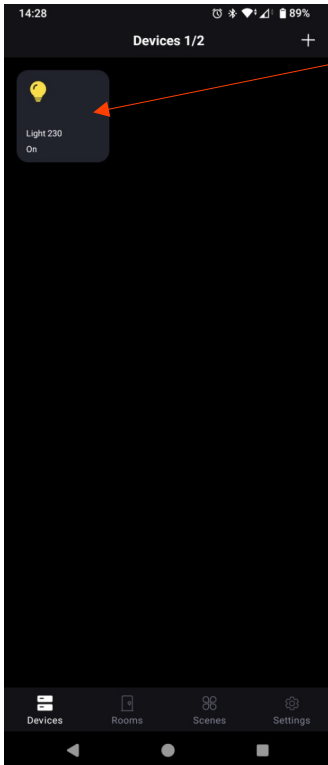

On the receiver page press the “...” option

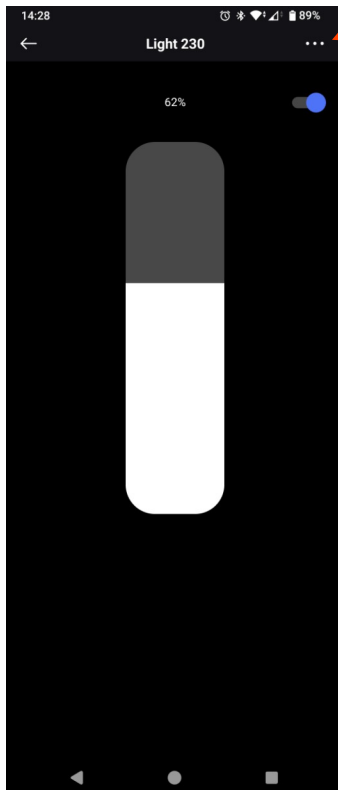

On the Device Settings page, press “Advanced Settings” then press “Enter Pairing Mode”

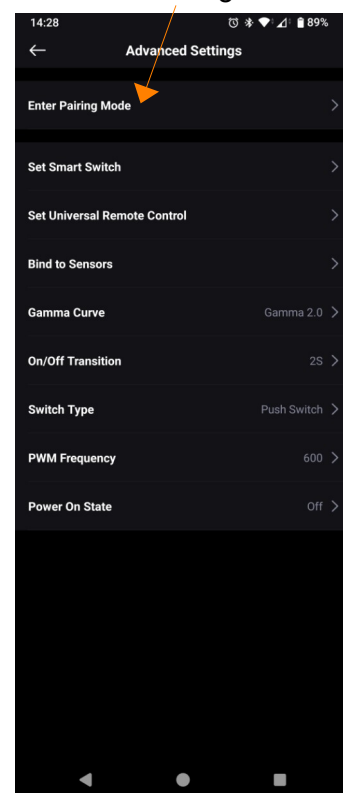
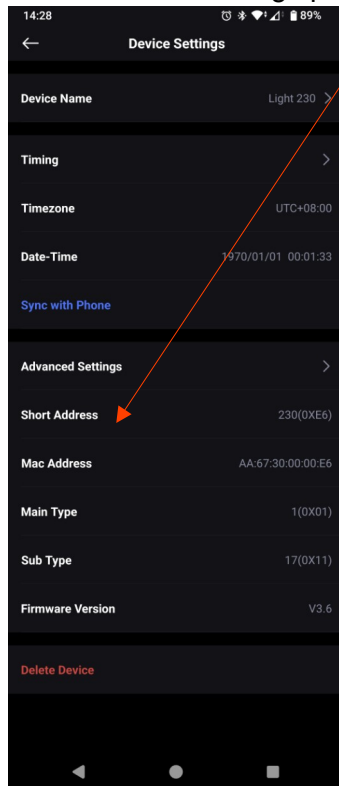

You will have a 5 second countdown on screen, during which time you must press the “on” button on the switch plate to pair the receiver.

Countdown location

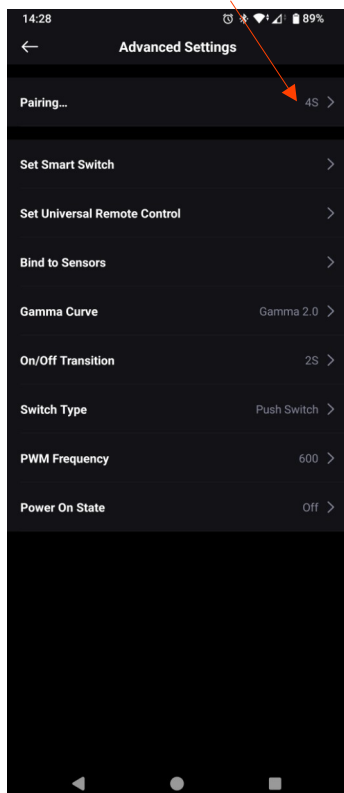

“On” button

