



H2A Backup And Copy Network Data on Homeelife App User Manual

SYSTEQ Limited

47 The Wenta Business Centre
Colne Way
Watford
Hertfordshire
WD24 7ND
United Kingdom

Tel: +44 (0)1923 605 301

Email: support@systeq.co.uk

Contents

Introduction	Page 3
Download existing data	Page 3
Backup new data	Page 7
Update or re-download data from QR code	Page 11
On mobile devices that need to re-download the same network	Page 11
On other mobile devices that have to update from a different network	Page 11

Introduction:

In this guide, you will be shown how to; Download existing data from a QR code to a mobile device, upload existing data to secure storage and copy existing data between mobile devices.

The QR codes are used to tell the app where to look in the secure storage for data.

Please note that QR codes from the H2A app are not compatible with homeelife and vise-versa.

Download existing data:

Install the app, open and sign up/sign in as shown in the guide on connecting a receiver to the homeelife app or switch-plate.

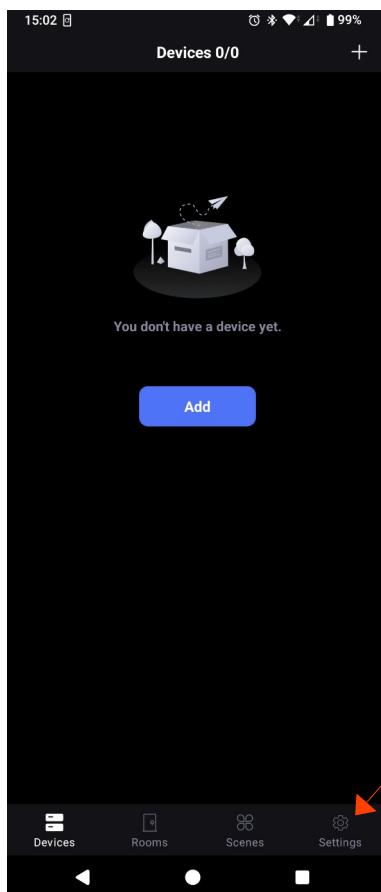

On your first opening of the app, it will show a screen with “You don’t have a device yet” on the screen. On the bottom left there is an icon of a gear with the word “Settings”, tap on this icon:

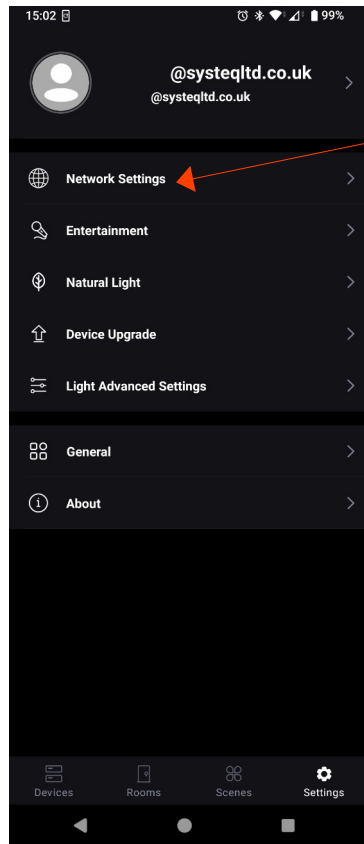

On the next screen tap on “Network settings”:

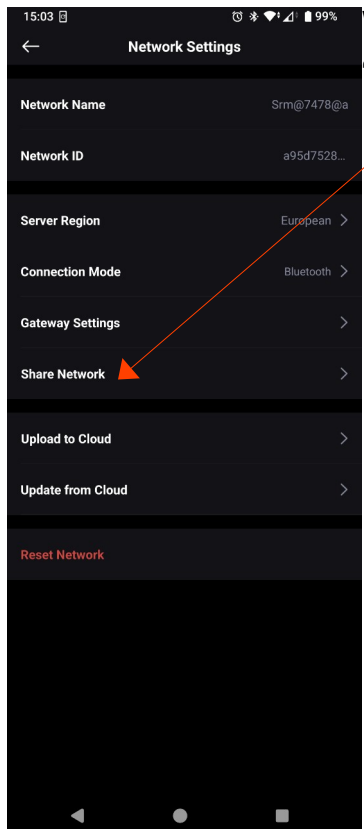

When you get onto the Network Settings screen tap on “Share Network”

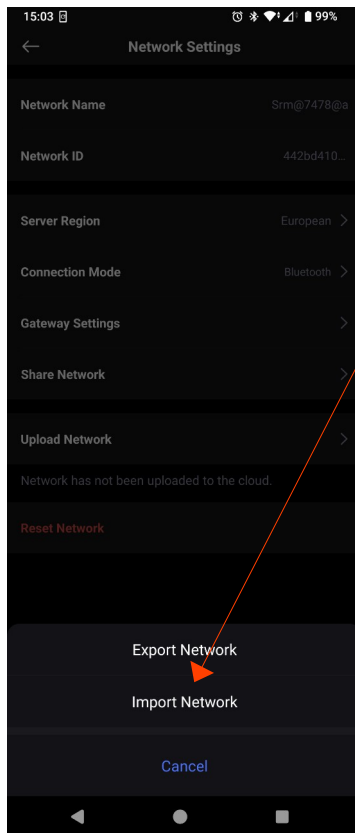

Tap on "Import Network"

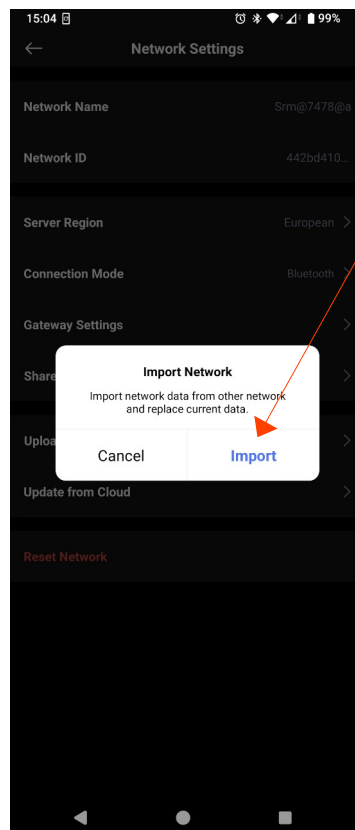

Tap on "Import", and if needed allow use of the camera, to scan the QR code of the network you want to import (you can scan from another device or from a printout)

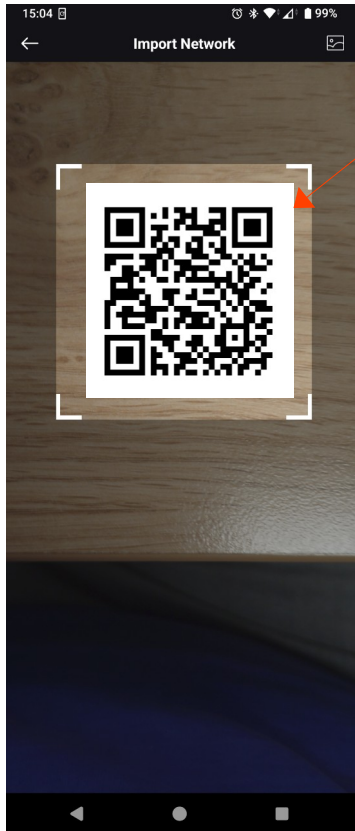

Once the QR code is aligned in the lighter area as shown to the left, the App will auto scan it.

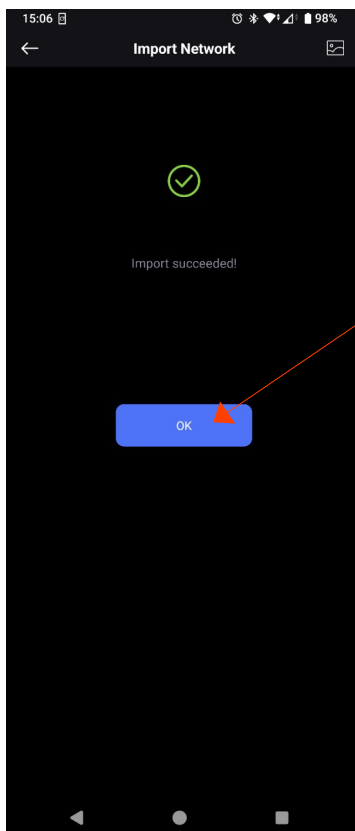

You will the see the test “Import succeeded”, and can tap “OK”. You will then find that the Devices, Rooms and Scenes tabs have updated.

Backup new data:



To backup your network to secure cloud storage, tap the gear with "Settings" underneath.

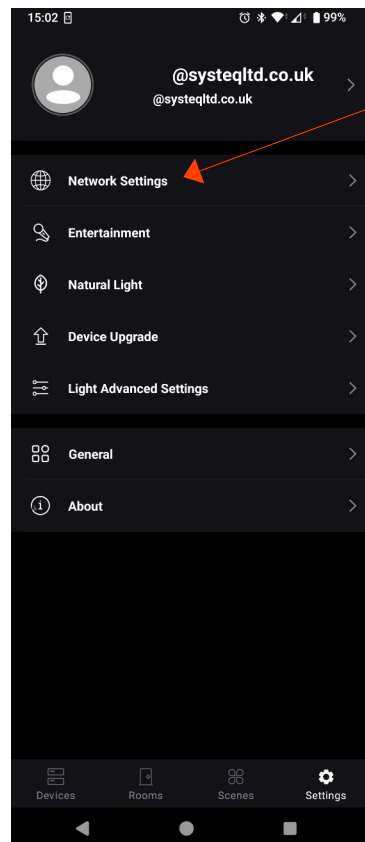

Press "Network Settings"

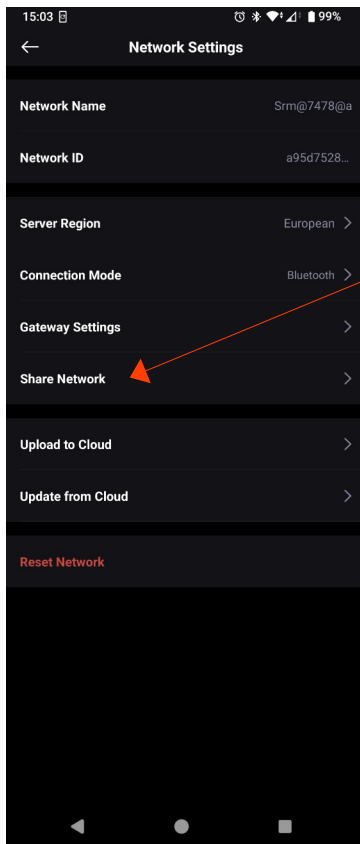

On the Network Settings screen tap on “Share Network”

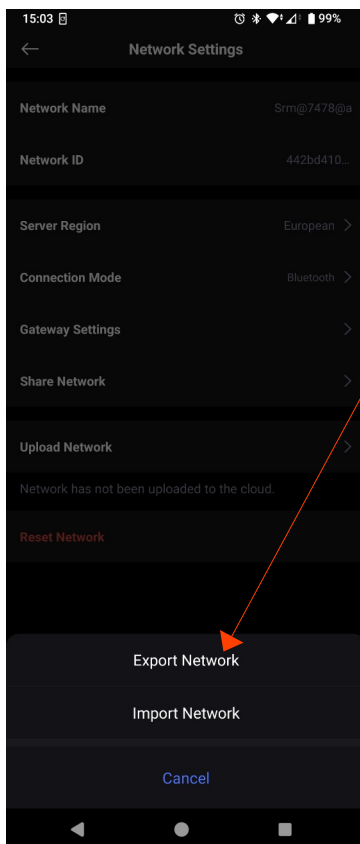

Press on “Export Network”

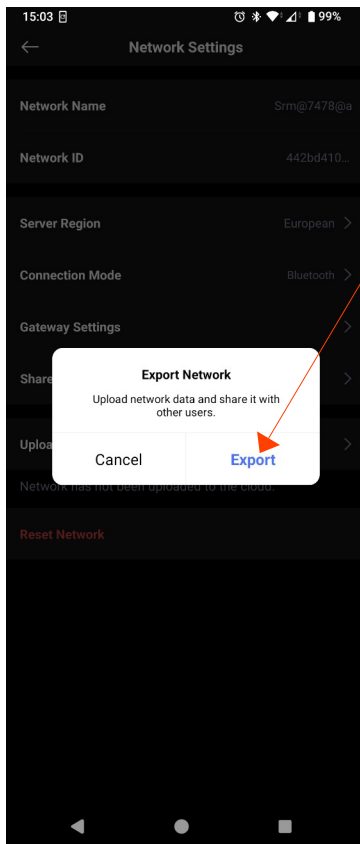

Tap on "Export" to save your data to the cloud.

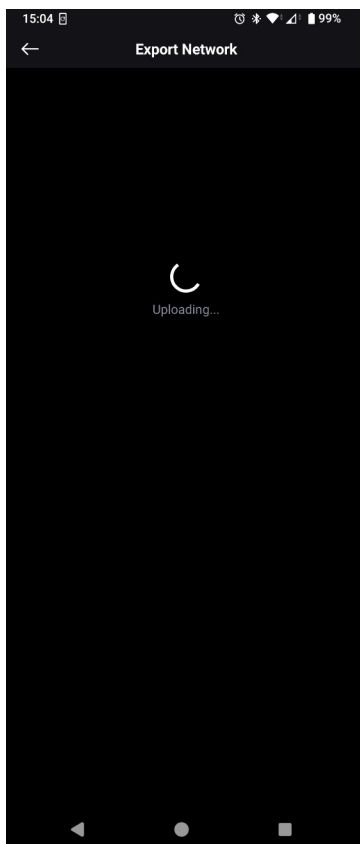

Wait for the data to upload.

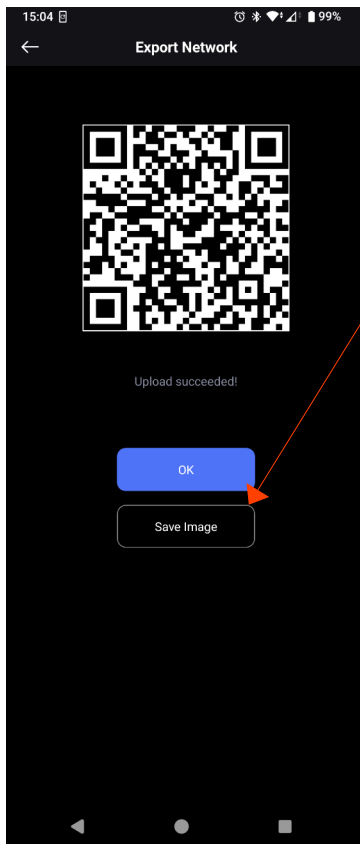

Once the network has successfully been exported we recommend that you save an image of the QR code as a backup or for ease of sharing the network.

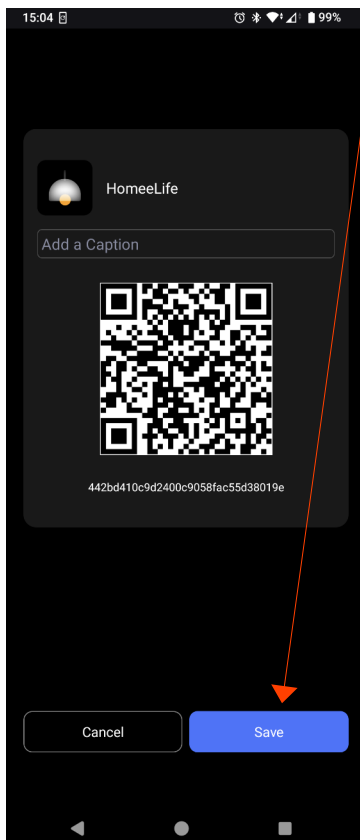

You can add a caption or just tap “Save” to save the image to your device.

Data can be copied between mobile devices using this QR code.

If you make any changes to the network, follow these steps again to update the cloud.

Please note: that once you upload the network you cannot roll back and will have to manually re-enter your previous settings.

Update or re-download data from QR code:

On the mobile devices that need to re-download the same network:

If the network have been updated by another device and you need to re-download the settings for your network, Follow the steps from “Download existing data” from page 3 and use the QR code you, or the other device saved from Exporting the data “As shown on page 10” for scanning the data.

On mobile devices that have a to update from a different network:

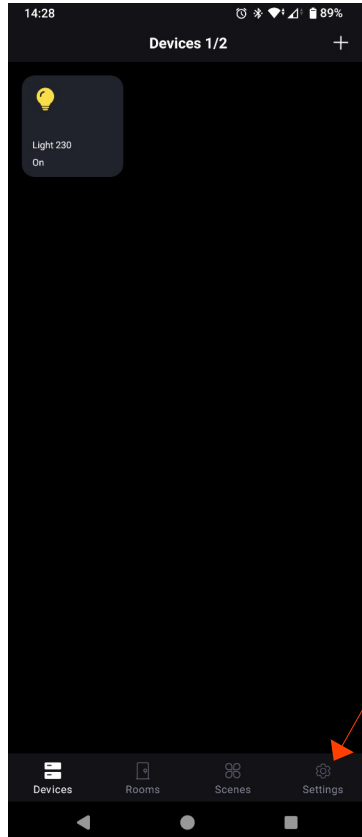

Open the app and tap on “Settings”

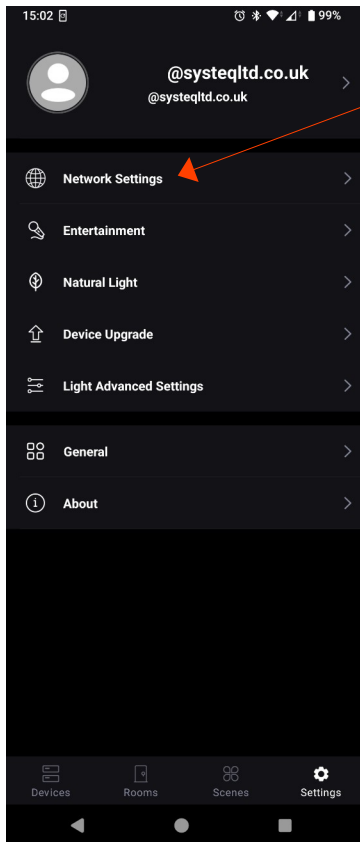

Tap on "Network Settings"

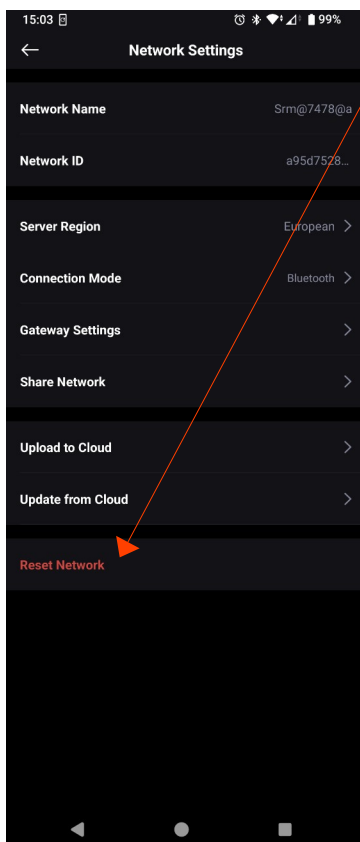

Press the option to "Reset Network".

Please note: This will erase all network settings on your device. If you have not made a cloud backup your network settings will be lost.

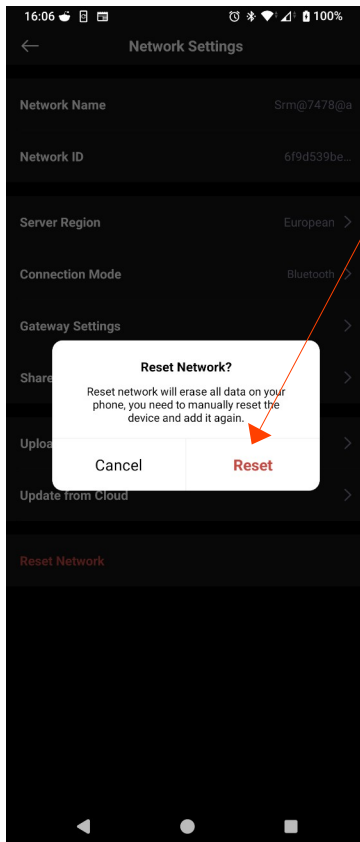

Tap "Reset" to confirm

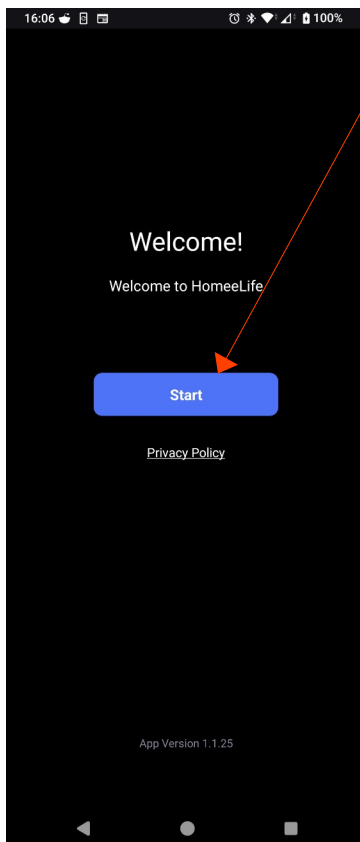

Once you have confirmed, you will be taken back to this screen.

Press "Start".

Follow the steps from "Download existing data" from page 3 in order to download the new network to your device.